

ROYAL LIGHT ELECTRONICS CO.,LTD.

Part Number: **B-2704W-5V(SMD)**

Page:1/3

Rev:00

■ Package Dimension:

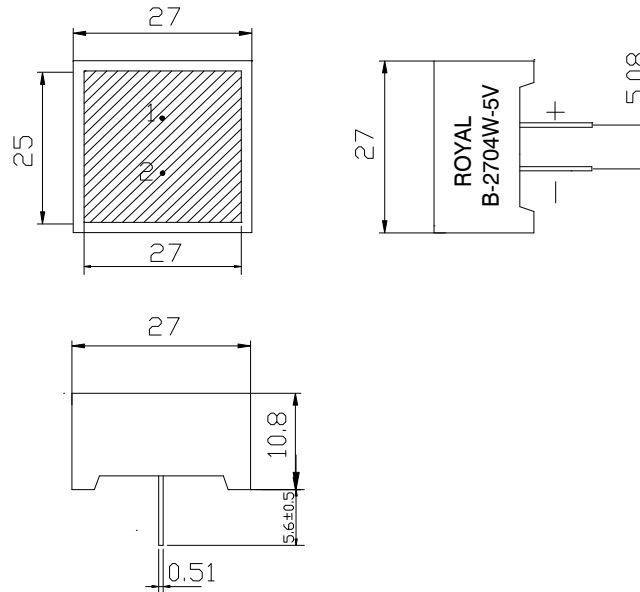

Pin Function

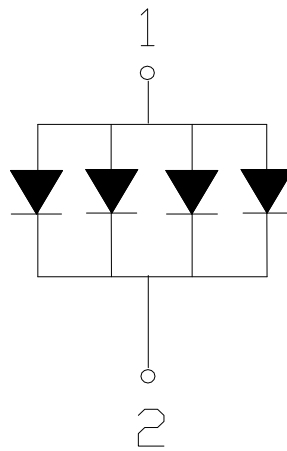

Part Number	Chip		CCorCA
	Material	Emitting Color	
B-2704W-5V(SMD)	InGaN/GaN	WHITE	CA

■ NOTES:

- 1.All dimensions are millimeters(inches)
- 2.Tolerance is $\pm 0.25\text{mm}(0.01\text{'})$ unless otherwise noted.
- 3.COLLOID COLOR: WHITE
- 4.FACE COLOR: WHITE

ROYAL LIGHT ELECTRONICS CO.,LTD.

Part Number: B-2704W-5V(SMD)

Page:2/3

Rev:00

1.SPECIFICATIONS						
(1) Absolute Maximum Rating (Ta=25°C)						
Item	Symbol	Absolute Maximum Rating			Unit	
Forward Current	IF	25			mA	
Peak Forward Current	IFP	100			mA	
Reverse Voltage	VR	5			V	
Power Dissipation	PD	170			mW	
Electrostatic Discharge(HBM)	ESD	500			V	
Operating Temperature	TOP	-40°C~80°C			°C	
Storage Temperature	TSTG	-40°C~100°C			°C	
Lead Soldering Temperature	TSOL	260°C FOR 5 SECONDS				
IFP Conditions: Pulse Width≤10msec.and duty ≤1/10						
(2) Initial Electrical/Optical Characteristics (Ta=25°C)						
Item	Symbol	Condition	Min	Typ	Max	Unit
Forward Voltage	VF	IF=20(mA)	2.8	3.2	3.8	V
Reverse Current	IR	VR=5(V)	/	/	100	μA
Luminous Intensity	IV	IF=10(mA)	10000	15000	/	ucd
Peak Wavelength	λ p	IF=20(mA)	/	/	/	nm
Dominant Wavelength	λ d	IF=20(mA)	/	/	/	nm
Recommend Forward Current (If Rec)	If(Rec)	/	/	20	/	mA
2.TYPICAL INITIAL OPTICAL/ELECTRICAL CHARACTERISTICS						
Please refer to Figures:in Page 3						
3.OUTLINE DIMENSIONS AND MATERIALS						
Please refer to drawing in page 2.						
Material as follows: Resin :Epoxy						

ROYAL LIGHT ELECTRONICS CO.,LTD.

Part Number: B-2704W-5V(SMD)

Page:3/3

Rev:00

Typical Electro-Optical Characteristic Curves:

Fig1.Forward Current vs.Forward Voltage

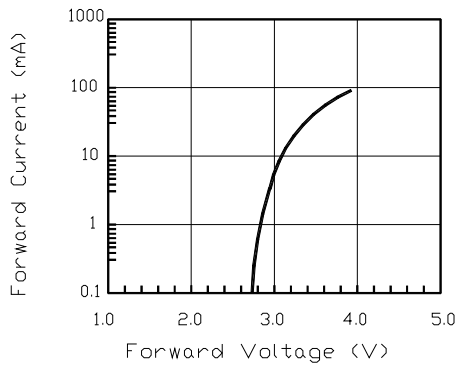

Fig2.Relative Intensity vs. Forward Current

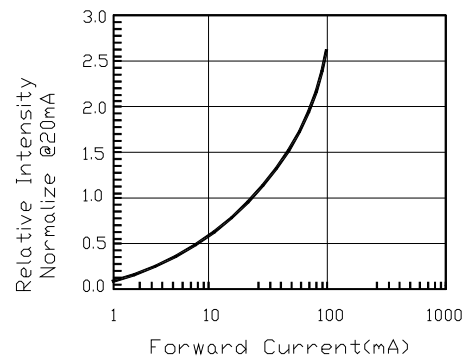

Fig3.Forward Voltage vs. Temperature

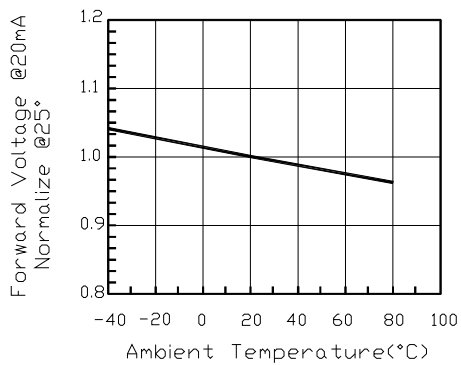
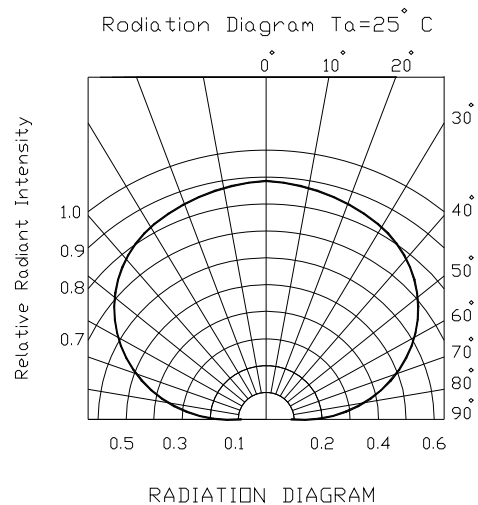
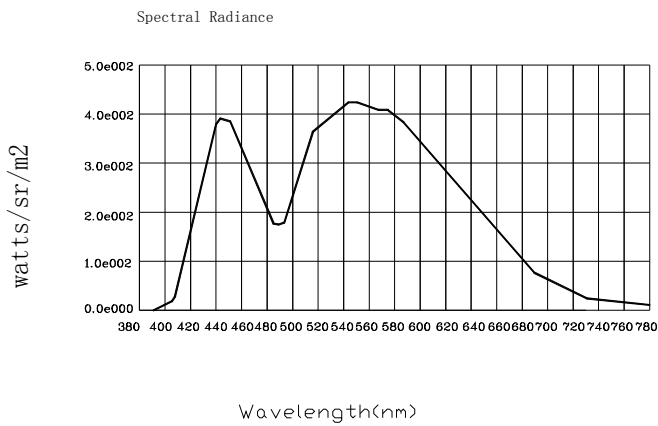
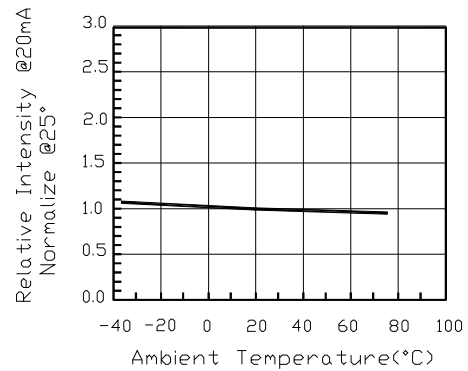

Fig4.Relative Intensity vs. Temperature



RADIATION DIAGRAM